

Tilting device for 6 m mast

The tilting device serves as stand for a telescopic mast. Telescopic mast and tilting device are free-standing, and do not need any staying. For maintenance purpose the telescopic mast can be tilted by means of a rope winch (optional accessory).

Specification

Part number: 4.3181.03.090

General

Height	1580 mm
Material	steel, galanised
Weight	60 kg

Versions

No other versions of this product are available.

Accessories

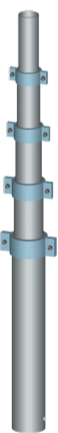
Product	Product name	Brief description
	Telescopic Mast 6 m 4.3180.30.090	For the mounting of meteorological measuring instruments. This telescopic mast can be used at a wall or in the open country, in combination with a respective tilting device, without staying. General Length 6 m Diameter 90 / 80 / 71 mm Top of Mast \varnothing 71 mm Material Aluminium (AlMgSi1) Weight 16 kg

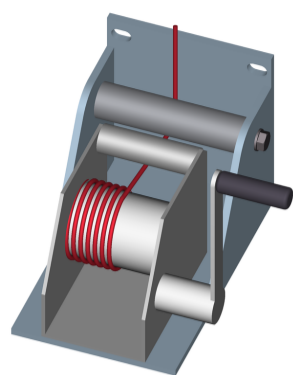

Winch for
tilting device 6
m
4.3182.03.090

The winch is used to tilt or erect the mast together with tilting device.

General

Material Steel, galvanised

Weight 23 kg

